

*BRICK INSERT
LETTERBOX*

INSTRUCTION

FLORENCIO 9X6 FRONT OPENING	BUZB02
SEÑOR 9X6 FRONT & BACK SET	BUZB01
BRUNO 14X6 FRONT OPENING	BUZB04
EMELIO 14X6 FRONT & BACK SET	BUZB03
BLANCA 14X6 FRONT & BACK SET	BUZB06
ELADIO LARGE BRICK IN FRONT & BACK SET	BUZB05



FLORENCIO

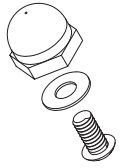

SCREWS X 8

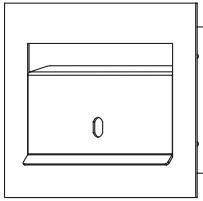

FACE PLATE

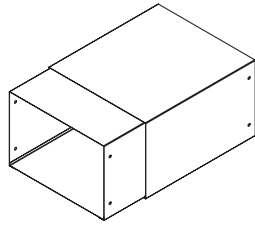

SLEEVE

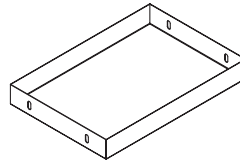

MAIL END CAP

SEÑOR

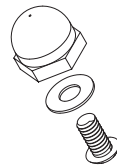

SCREWS X 8

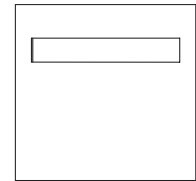

FACE PLATE

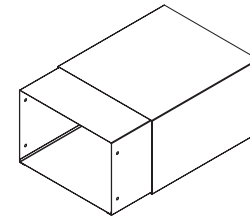

SLEEVE

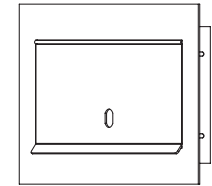

BACK PLATE

EMELIO

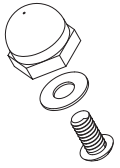

SCREWS X 8

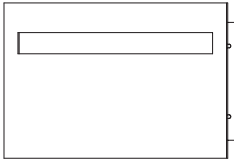

FACE PLATE

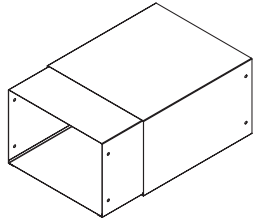

SLEEVE

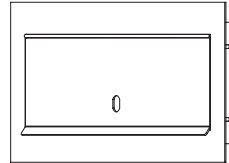

BACK PLATE

BRUNO

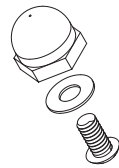

SCREWS X 8

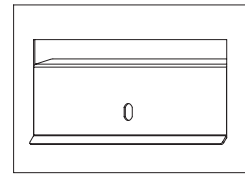

FACE PLATE

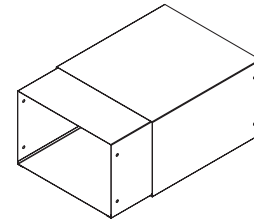

SLEEVE

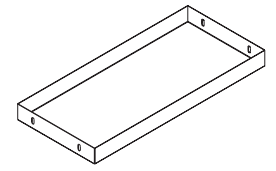

MAIL END CAP

BLANCA

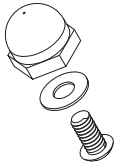

SCREWS X 8

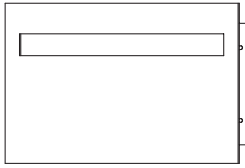

FACE PLATE

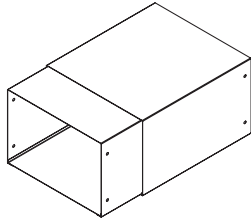

SLEEVE

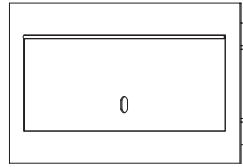

BACK PLATE

ELADIO

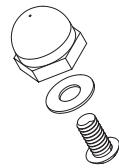

SCREWS X 14
6 for fixing the
mail tube

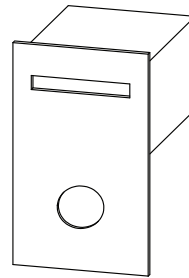

FRONT PLATE
attached to front
sleeve

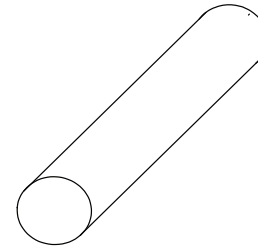

500MM PIPE

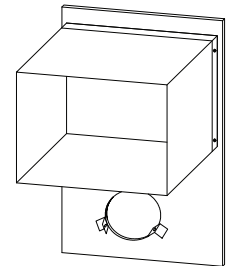

BACK PLATE
attached to
back sleeve

PREPARING YOUR EXPANDABLE SLEEVE

FOR BRICK PILLARS 1 BRICK DEEP (230mm)

Unscrew the rear face plate from the rear sleeve and reattach it to the front 230mm sleeve.

FOR ALL OTHER BRICK PILLARS (Brick pillar 1 to 2 bricks deep)

Your sleeve is expandable. It comes ready to use for brick pillar depths in between 230mm and 500mm

MAIL TUBE PREPARATION (Eladio)

1. Cut your PVC pipe to the correct size of your brick pillar.
2. Place the PVC pipe into the mounting brackets of the letterbox and mark out 3 drill points on each end using a pencil
3. Drill the holes into the PVC and attach tube into mailbox on both ends, using screws provided.



SENOR / FLORENCIO



BRUNO / EMELIO / BLANCA

STEP 1

Build up brickwork to the desired height of your letterbox, remembering to add the usual mortar thickness on top.

STEP 2

Sit your letterbox in place on the pillar, ensuring that the sleeve is adjusted for a snug fit with the front and back of the brick pillar.

STEP 3

Cut bricks and build up the sides of the letterbox, again using the normal mortar in between letterbox sleeve and bricks.

STEP 4

Complete Brickwork.



ELADIO

STEP 1

Build up brickwork to the desired height of the mail tube on your letterbox, remembering to add the usual mortar thickness on top.

STEP 2

Cut Bricks to allow a 130mm wide gap for the mail tube to sit into. On the first brick level for your mail tube, it is ideal to start the base of the PVC tube at 58mm above the top of the grout line.

For this, we recommend cutting a short brick of approx 48mm height to elevate the tube (Add the standard 10mm mortar on top of your short brick.) This will ensure that later on your expandable mail sleeve will be neatly in place with the bricks above.

Sit letterbox (bottom of mail tube) into the space you have created and build up the next level of bricks, filling in the space around the tube with grout.

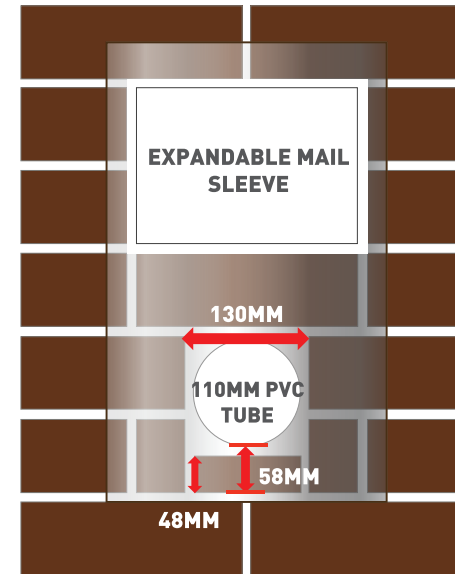

STEP 3

Build another level of bricks between the mail tube and expandable sleeve again ensuring that the grout is snug underneath the sleeve, providing support.

STEP 4

Cut bricks and build up the sides of the letterbox, again using the normal mortar in between letterbox sleeve and bricks.

STEP 5

Build up the sides of the sleeve and complete brickwork.